

T20 SGRIP MOST - TIG welding torch

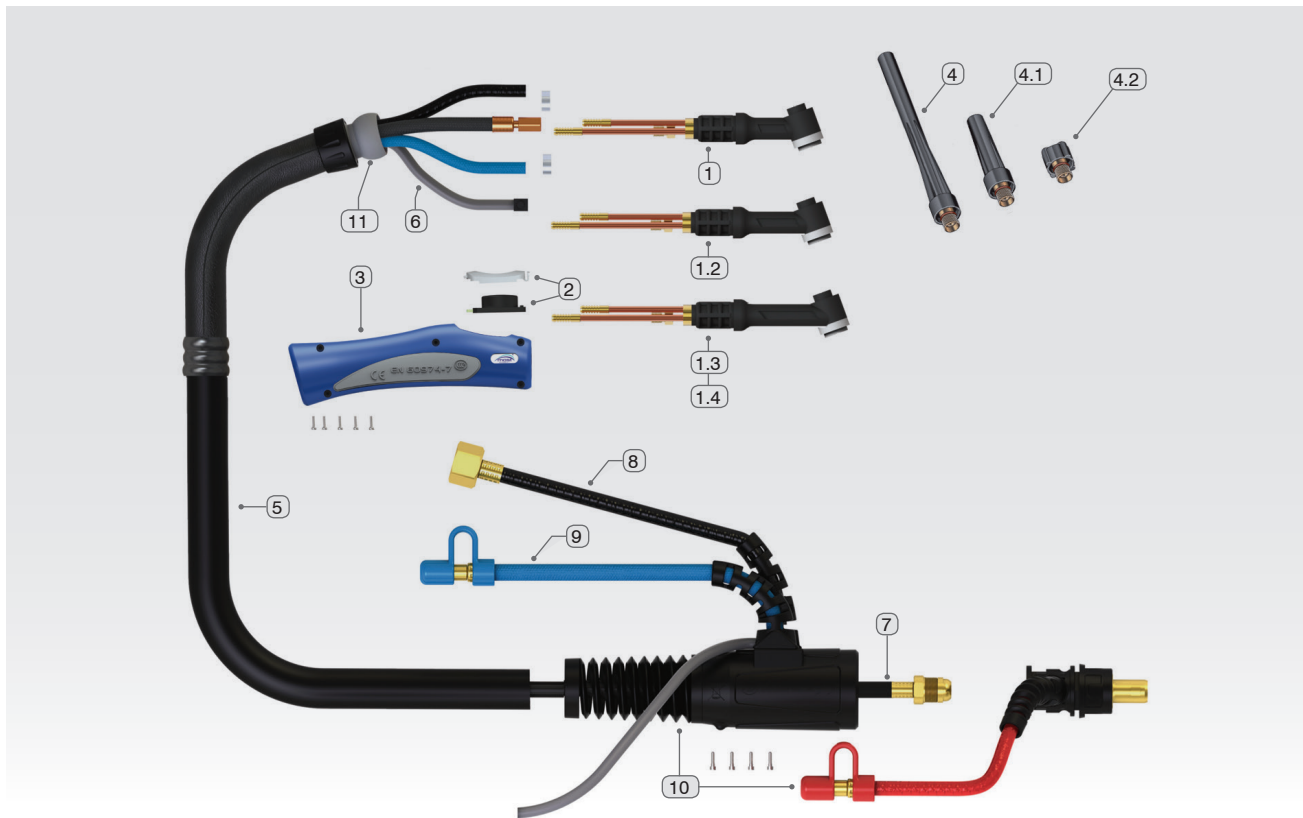

Model	T20 SGRIP
Cooling	Liquid
Technical data according to EN 60 974-7:	160 A AC / 225 A DC
▪ Rating 100% duty cycle	1,0-3,2 mm
▪ Tungsten electrode diameter	5-12 l/min
▪ Gas flow	
Length / Catalogue No.	4,0 m / 56 01 062004 8,0 m / 56 01 062008 12,0 m / 56 01 062012

T20F SGRIP version with a flexible torch, technical data as for T26 SGRIP.

Torches are supplied without control plugs.

V - torch with gas valve, without button.

F - flexible torch.

DC - direct current.

AC - alternating current.

No.	Replaceable elements	Catalogue No.	Alternative designation
1	SR-20W MOST* torch body	56 13 003375	-
1.1	SR-20F MOST torch body	56 13 200008	-
1.2	T-20F torch body L=75 mm	56 13 003466	-
1.3	T-20F torch body L=100 mm	56 13 003467	-
1.4	T-20F torch body L=125 mm	56 13 003468	-
2	Set button ON/OFF	56 13 200100	UER1MS

No.	Replaceable elements	Catalogue No.	Alternative designation
3	Small handle TSGRIP	56 13 200221	RY-ERH100
4	Long back cup T-9/20	56 13 003170	41V24
4.1	Medium back cup T-9/20	56 13 003250	41V35
4.2	Short back cup T-9/20	56 13 003280	41V33
5	Cable cover (m)	51 12 015289	-
5.1	Cable cover 4 m	56 13 200197	USLERCO100-40
5.2	Cable cover 8 m	56 13 200198	USLERCO100-80
5.3	Cable cover 12 m	56 13 200199	USLERCO100-120
6	Control cable 4 m	56 13 200217	UERSWL4
	Control cable 8 m	56 13 200218	UERSWL8
	Control cable 12 m	56 13 200219	UERSWL12
7	20W SGRIP 4 m power water cable	56 13 200208	USL45V03AOB
	20W SGRIP 8 m power water cable	56 13 200209	USL45V04AOB
	20W SGRIP 12 m power water cable	56 13 200210	USL45V37AOB
8	Gas line, set 4 m	56 13 200187	U45V09-GS5
	Gas line, set 8 m	56 13 200188	U45V10-GS5
	Gas line, set 12 m	56 13 200189	U45V09-37-GS5
9	Blue water hose 4 m	56 13 200190	UN45V07OB-WF1
	Blue water hose 8 m	56 13 200191	UN45V08OB-WF1
	Blue water hose 12 m	56 13 200192	UN45V07-37OB-WF1
10	TIG 18/20 plug assembly	56 13 200273	UNSL 35-50-1820-WR1
11	TIG joint	56 13 200266	UERKJ100

* standard version