

# M401 / M501 SGRIP - MIG/MAG torch

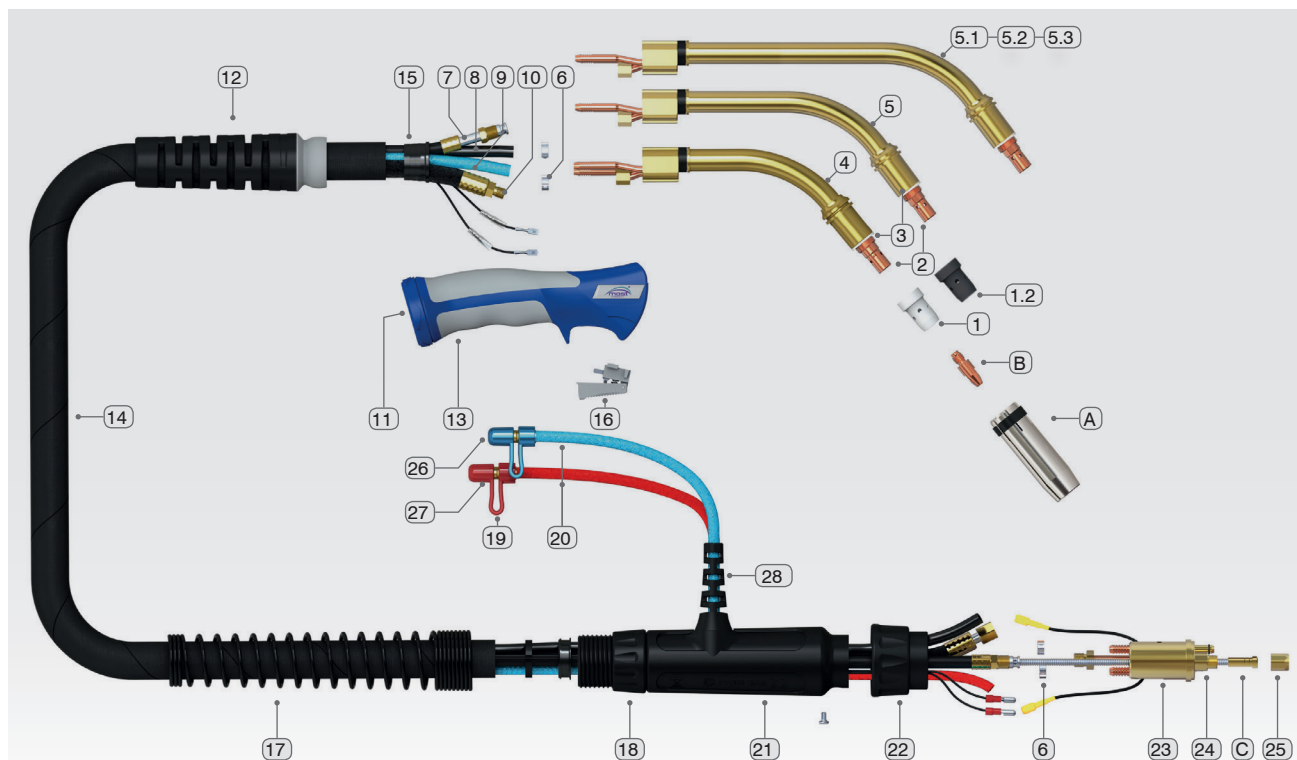

Model	M401 SGRIP	M 501 SGRIP
<b>Cooling</b>	Liquid	Liquid
<b>Technical data according to EN 60 974-7:</b>		
▪ Rating 60% duty cycle	400 A - CO <sub>2</sub> 300 A - mix M21 0,8-1,6 mm	520 A - CO <sub>2</sub> 420 A - mix M21 0,8-1,6 mm
▪ Wire diameter		
<b>Length / Catalogue No.</b>	3,0 m/55 08 304013 4,0 m/55 08 304014 5,0 m/55 08 304015	3,0 m/55 08 305013 4,0 m/55 08 305014 5,0 m/55 08 305015

No.	Replaceable elements	Catalogue No.
A	<b>Straight gas nozzle 20x76</b>	55 13 000610
	<b>Conical gas nozzle 16x76*</b>	55 13 000600
	<b>Conical gas nozzle 14x76</b>	55 13 000615
	<b>Spot welding gas nozzle</b>	55 13 000613
	<b>Reinforced conical gas nozzle 16x76 HD</b>	55 13 000617
1	<b>401/501 gas diffuser ceramic white*</b>	55 13 009493
1.1	<b>401/501 gas diffuser white</b>	55 13 009491
1.2	<b>401/501 gas diffuser black</b>	55 13 009498
2	<b>M401/501 M6x25 contact tip holder</b>	55 13 003991
2.1	<b>M401/501 M6x29 contact tip holder</b>	55 13 003993
2.2	<b>M401/501 M8x25* contact tip holder</b>	55 13 003990
2.3	<b>M401/501 M8x29 contact tip holder</b>	55 13 003992
3	<b>Insulating washer M401/501</b>	55 13 013966
4	<b>M401 SGRIP* swan neck</b>	55 13 014086
5	<b>M501 SGRIP* swan neck</b>	55 13 014096
5.1	<b>M501L swan neck L=300 mm</b>	55 13 01409A
5.2	<b>M501XL swan neck L=400 mm</b>	55 13 01409B
5.3	<b>M501XXL swan neck L=500 mm</b>	55 13 01409C
6	<b>GER 9,5 clamp</b>	50 15 000095

No.	Replaceable elements	Catalogue No.
7	<b>Insert-on cable</b>	(3 m) 55 13 006503 (4 m) 55 13 006504 (5 m) 55 13 006505
8	<b>Black gas pipe</b>	55 13 015370 (m)
9	<b>Blue hose 5x1,5</b>	51 13 007120 (m)
10	<b>Power water cable</b>	(3 m) 55 13 015968 (4 m) 55 13 015969 (5 m) 55 13 015970
11	<b>MOST torch nut UG8008</b>	55 13 006837
12	<b>MOST torch stiffener 401/501 UG 3208</b>	55 13 006831
13	<b>MOST torch grip MSGRIP UG2514/KJ/B</b>	55 13 006515
14	<b>External cable cover set</b>	(3 m) 55 13 015530 (4 m) 55 13 015531 (5 m) 55 13 015532
14.1	<b>External cable cover</b>	51 13 007201 (m)
15	<b>MOST Rim 401/501 UG 8010</b>	55 13 006830
16	<b>MOST trigger M15/501 UG2516</b>	55 13 006517
17	<b>MOST euro plug spring M401/501</b>	55 13 006827
18	<b>MOST euro plug spring nut M36/501</b>	55 13 006828
19	<b>Quick coupling plug for hose Ø6</b>	50 14 182003
20	<b>Red hose 5x15</b>	51 13 007115
20.1	<b>Blue hose 5x1,5</b>	51 13 007120
21	<b>MOST euro plug connector M401/501</b>	55 13 006522
22	<b>MOST euro plug nut M15/501 B1519</b>	55 13 006519
23	<b>Integrated water connector UB5098</b>	55 13 006570
24	<b>O-ring 4x1</b>	55 13 013962
25	<b>Special insert nut</b>	55 13 004300
26	<b>UBD 80310 red plug</b>	55 13 006838
27	<b>UBD 80320 blue plug</b>	55 13 006840
28	<b>Cable stiffener</b>	56 13 200265
B	<b>M8x30 contact tip</b>	
C	<b>Liners</b>	

\* standard version

RYWAL-RHC Sp. z o.o.  
ul. Polna 140B, 87-100 Toruń  
export@rywal.com.pl

