

# M25 SGRIP - MIG/MAG torch

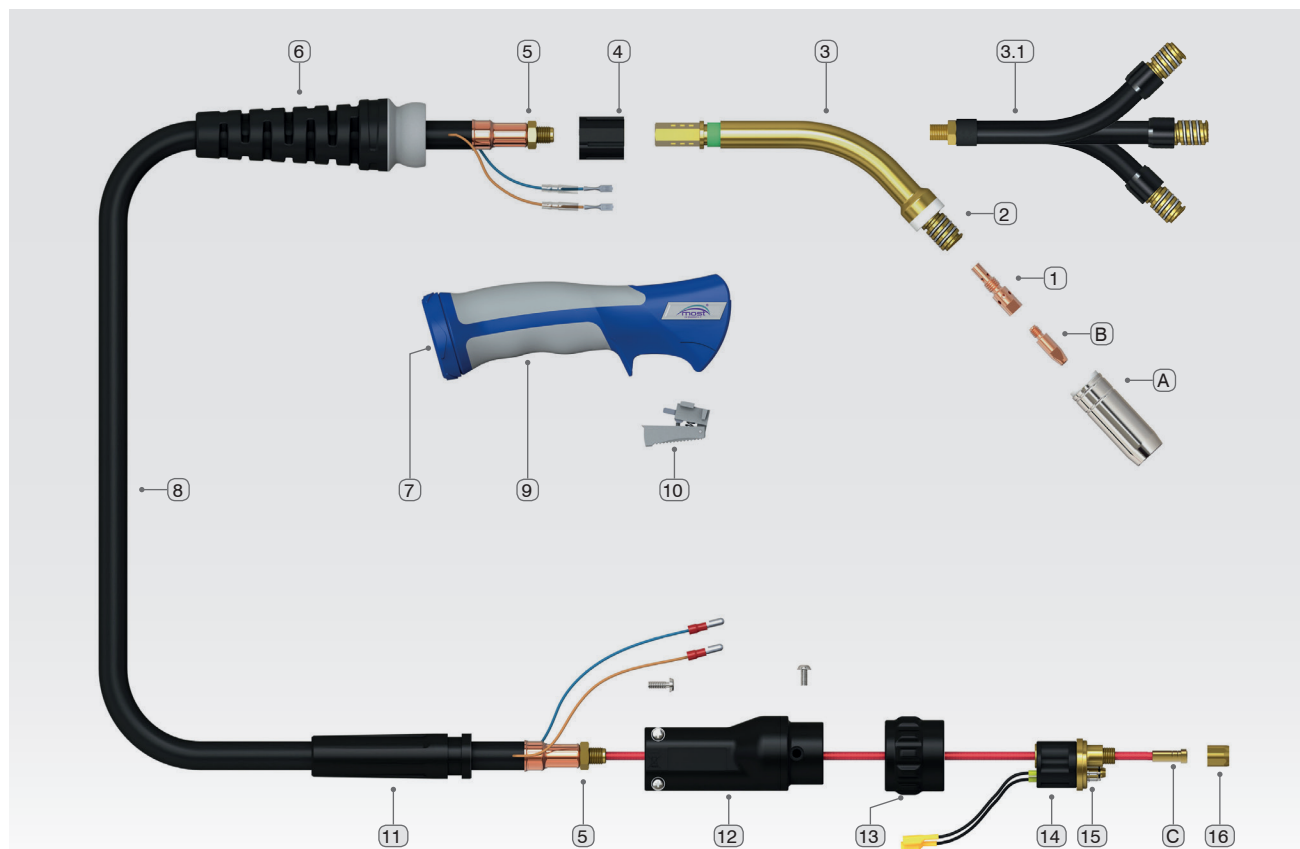

Model	M25 SGRIP
<b>Cooling</b>	Gas
<b>Technical data according to EN 60 974-7:</b>	
▪ Rating 60% duty cycle	230 A - CO <sub>2</sub> 200 A - mix M21
▪ Wire diameter	0,8-1,2 mm
<b>Length / Catalogue No.</b>	3,0 m / 55 08 302530 4,0 m / 55 08 302540 5,0 m / 55 08 302550

No.	Replaceable elements	Catalogue No.
4	Connector body	55 13 013258
5	M10x1 low nut	55 13 004309
6	MOST torch stiffener M15/25 UG8015	55 13 006834
7	MOST torch nut UG8008	55 13 006837
8	Welding cable M-25 3 m	55 13 016093
8.1	Welding cable M-25 4 m	55 13 016094
8.2	Welding cable M-25 5 m	55 13 016095
9	MOST torch grip MSGRIP UG 2514/KJ/B	55 13 006515
10	MOST trigger M15/501 UG2516	55 13 006517
11	MOST stiffener for euro plug M15/25 UC2841	55 13 006835
12	MOST euro plug connector M15/36 UC1518	55 13 006518
13	MOST euro plug nut M15/501 UC1519	55 13 006519
14	Integrated connector	55 13006569
15	O-ring 4x1	55 13 013962
16	Special insert nut	55 13 004300
B	M6x28 contact tip	
C	Liners	

No.	Replaceable elements	Catalogue No.
A	Straight gas nozzle 18x57 Conical gas nozzle 15x57* Conical gas nozzle 11,5x57 Spot welding gas nozzle	55 12 300901 55 12 300900 55 12 300904 55 12 300903
1	M25* contact tip holder	55 13 003804
2	M25* spring	55 13 008360
3	M-25 without nozzle and tip*	55 13 014072
3.1	M-25 flexible swan neck without nozzle and tip	55 13 01407F

\* standard version