

# M24 SGRIP - MIG/MAG torch

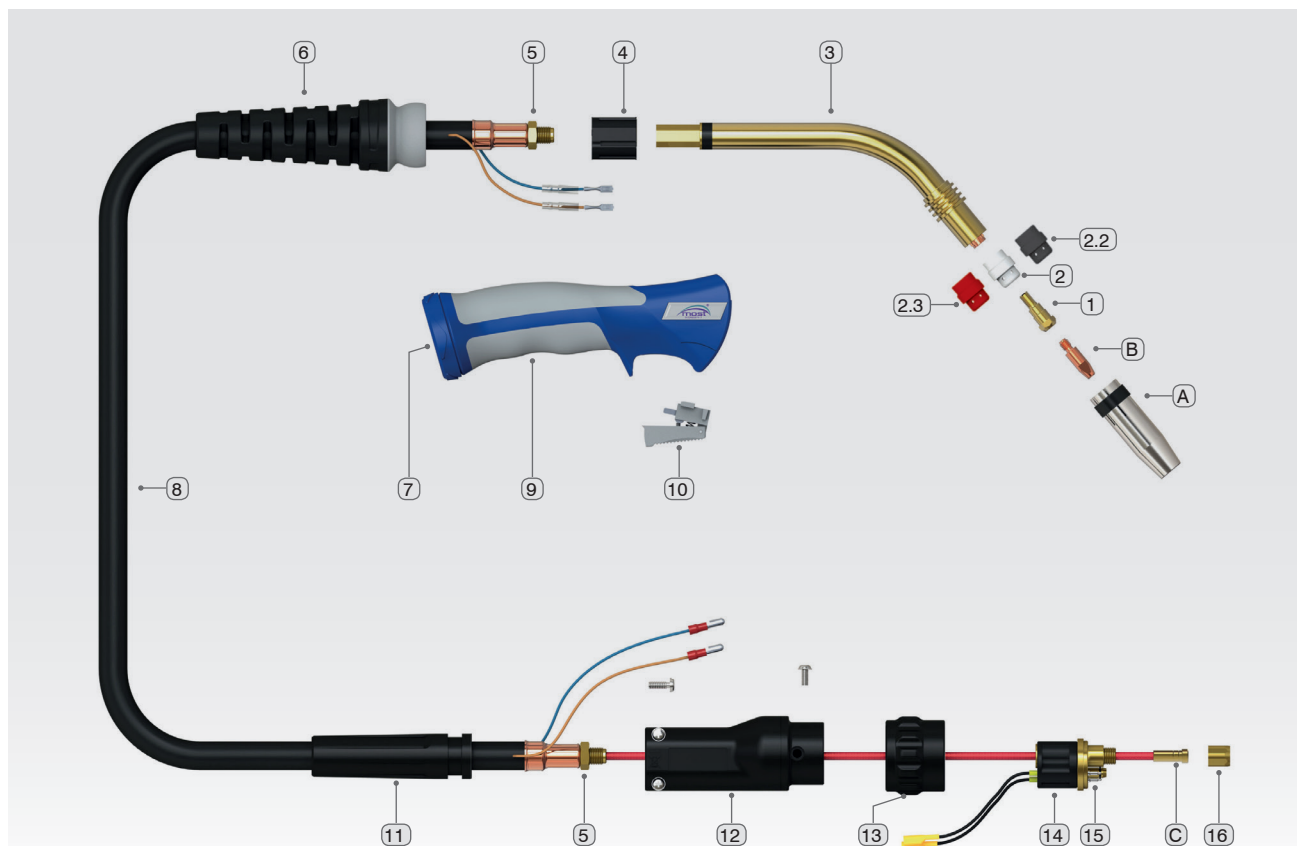

Model	M24 SGRIP
<b>Cooling</b>	Gas
<b>Technical data according to EN 60 974-7:</b>	
▪ Rating 60% duty cycle	250 A - CO <sub>2</sub> 220 A - mix M21
▪ Wire diameter	0,8-1,2 mm
<b>Length / Catalogue No.</b>	3,0 m / 55 08 302430 4,0 m / 55 08 302440 5,0 m / 55 08 302450

No.	Replaceable elements	Catalogue No.
3	<b>M24 swan neck</b>	55 13 014063
4	<b>Connector body</b>	55 13 013258
5	<b>M10x1 low nut</b>	55 13 004309
6	<b>MOST torch stiffener M15/25 UG8015</b>	55 13 006834
7	<b>MOST torch nut UG8008</b>	55 13 006837
8	<b>MOST welding cable M24 3 m</b>	55 13 016093
8.1	<b>MOST welding cable M24 4 m</b>	55 13 016094
8.2	<b>MOST welding cable M24 5 m</b>	55 13 016095
9	<b>MOST torch grip M GRIP UG2514/KJ/B</b>	55 13 006515
10	<b>MOST trigger M15/501 UG2516</b>	55 13 006517
11	<b>MOST stiffener for euro plug M15/25 UC2841</b>	55 13 006835
12	<b>MOST euro plug connector M15/36 UC1518</b>	55 13 006518
13	<b>MOST euro plug nut M15/25 UC1519</b>	55 13 006519
14	<b>Integrated connector UC1528</b>	55 13 006569
15	<b>O-ring 4x1</b>	55 13 013962
16	<b>Special insert nut</b>	55 13 004300
B	<b>M6x28 contact tip</b>	<a href="#">(table p. 49)</a>
C	<b>Liners</b>	<a href="#">(table p. 49)</a>

No.	Replaceable elements	Catalogue No.
A	<b>Straight gas nozzle 17x63,5</b> <b>Conical gas nozzle 12,5x63,5*</b> <b>Conical gas nozzle 10x63,5</b>	55 12 300897 55 12 300895 55 12 300896
1	<b>M6* contact tip holder</b>	55 13 003800
2	<b>M-24 gas diffuser ceramic white*</b>	55 13 009460
2.1	<b>M-24 gas diffuser, white</b>	55 13 009465
2.2	<b>M-24 gas diffuser, black</b>	55 13 009464
2.3	<b>M-24 silicone gas diffuser</b>	55 13 009467

\* standard version