

M240 SGRIP - MIG/MAG torch

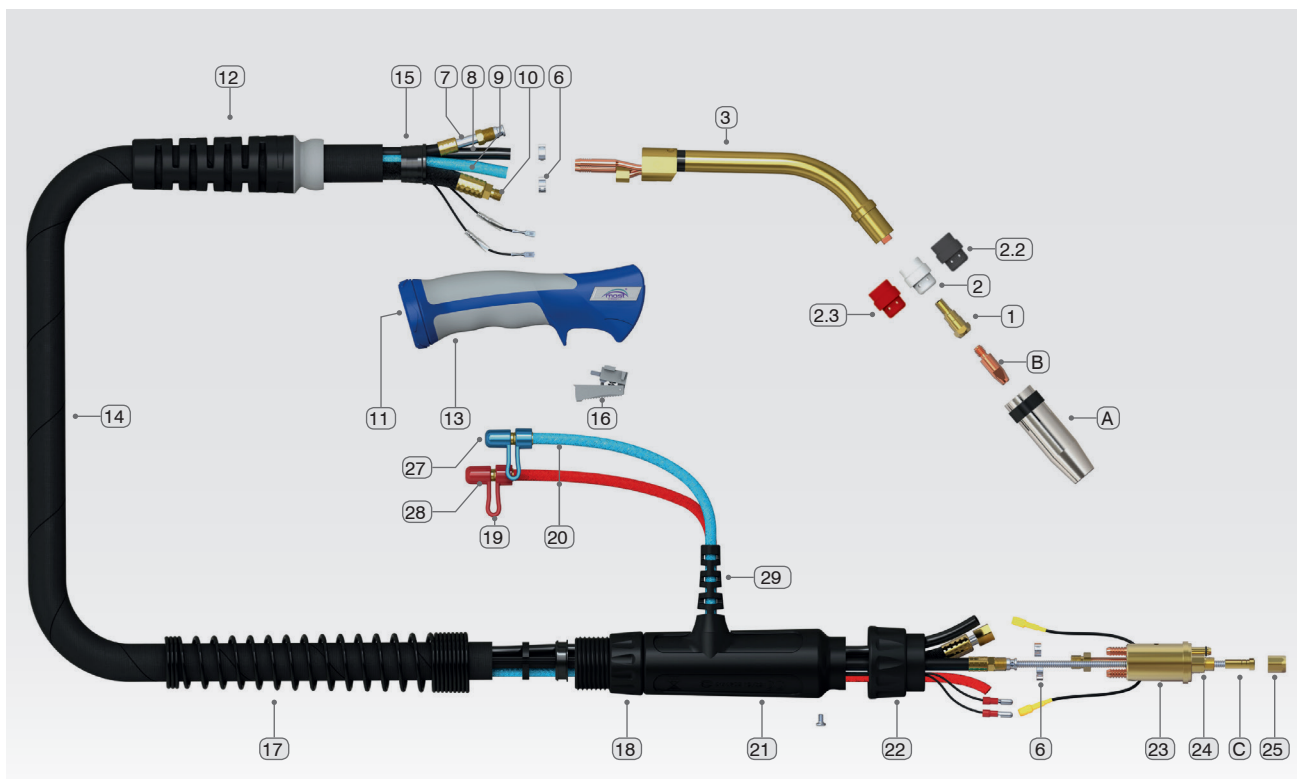

Model	M240 SGRIP
Cooling	Liquid
Technical data according to EN 60 974-7:	
▪ Rating 60% duty cycle	300 A - CO ₂ 270 A - mix M21
▪ Wire diameter	0,8-1,2 mm
Length / Catalogue No.	3,0 m / 55 08 304243 4,0 m / 55 08 304244 5,0 m / 55 08 304245

No.	Replaceable elements	Catalogue No.
11	MOST torch nut UG8008	55 13 006837
12	MOST torch stiffener 401/501 UG 3208	55 13 006831
13	MOST torch grip MSGRIP UG2514/KJ/B	55 13 006515
14	External cable cover set	(3 m) 55 13 015530 (4 m) 55 13 015531 (5 m) 55 13 015532
14.1	External cable cover	51 13 007201 (m)
15	MOST rim 401/501 UG 8010	55 13 006839
16	MOST trigger M15/501 UG2516	55 13 006517
17	MOST M401/501 euro plug spring	55 13 006827
18	MOST euro plug spring nut M36/501	55 13 006828
19	Quick coupling plug ø6	50 14 182003
20	Red hose 5x15	51 13 007115
20.1	Blue hose 5x1,5	51 13 007120
21	MOST euro plug cover M401/501	55 13 006522
22	MOST euro plug nut M15/501 B1519	55 13 006519
23	Integrated water connector UB5098	55 13 006570
24	O-ring 4x1	55 13 013962
25	Special insert nut	55 13 004300
27	UBD 80310 red plug	55 13 006838
28	UBD 80320 blue plug	55 13 006840
29	Cable stiffener	56 13 200265
B	Contact tip M6x28	
C	Liners	

No.	Replaceable elements	Catalogue No.
A	Straight gas nozzle 17x63,5 Conical gas nozzle 12,5x63,5* Conical gas nozzle 10x63,5	(3 m) 55 12 300897 (4 m) 55 12 300895 (5 m) 55 12 300896
1	M6* contact tip holder	55 13 003800
2	M-24 gas diffuser ceramic white*	55 13 009460
2.1	M-24 gas diffuser, white	55 13 009465
2.2	M-24 gas diffuser, black	55 13 009464
2.3	M-24 silicone gas diffuser	55 13 009467
3	M240 swan neck	55 13 014082
7	Insert-on cable	(3 m) 55 13 006503 (4 m) 55 13 006504 (5 m) 55 13 006505
8	Black gas pipe	55 13 015370 (m)
9	Blue hose 5x1,5	51 13 007120 (m)
10	Power-water cable	(3 m) 55 13 015968 (4 m) 55 13 015969 (5 m) 55 13 015970

* standard version