

Inverter plasma cutting machines

71/101 FANCUT MOST



FANCUT 71 and FANCUT 101 are modern, lightweight devices for cutting metal by air plasma.

- Small size and weight.
- PT-80/100 series plasma torches 6 meters long.
- BACK STRIKING plasma arc ignition, which significantly extends the service life of spare parts, especially in comparison to the high frequency HF ignition.
- Easy to use and modern panel.
- Grid cutting mode: the plasma arc is also maintained when passing through gaps in the material.
- Electro-gauging with suitable parts - available.
- Contact cutting (touching the metal with cutting nozzle) or space cutting.
- The air pressure regulator is located at the front of the machine.



Accessories available:

- Caliper PT-80 Compass Z0134AA - 59 25 000102.
- Caliper PT-100 Compass Z0143ZA - 59 25 000104.
- Bevel Tool 51880 for PT 80 - 59 25 000106.
- Bevel Tool 51887 for PT 100 - 59 25 000107.
- AT-1000 - 59 00 240036 air filter.
- Exchangeable paper insert for AT-1000 - 59 00 240037.
- Filter adapter AT-1000 (inlet/outlet accessories) - 59 00 240038.

The device is supplied with PT Plasma Torch 80/PT100 - 6 m long with double-pointed spacer, earth cable, user's manual and starter kit for cutting.

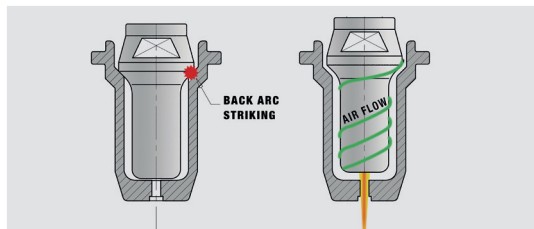

BACK STRIKING plasma arc scheme.

Model	FANCUT 71	FANCUT 101
Main voltage: -10% / + 15%	3x400 V / 50-60 Hz	3x400 V / 50-60 Hz
Network protection	16 A	20 A
Max current I_1	16 A	21,5 A
Max effective current I_{1eff}	12 A	15 A
Power consumption (X=60%)	11 kVA	16 kVA
Cutting current range	20-70 A	8-100 A
Idle Voltage U_0	280 V	310 V
Cutting current (X=100%) I_2	55 A	75 A
Cutting current (X=60%) I_2	70 A	100 A
Max. thickness of qualitative carbon steel cutting	25 mm	30 mm
Recommended thickness of qualitative carbon steel cutting	18 mm	22 mm
Separating cutting	35 mm	40 mm
Duty air pressure (for torch in length 6 m)	5,5-6,0 bar	5,5-6,0 bar
Plasma-generating gas	Compressed air	Compressed air
Max. air pressure	10 bar	10 bar
Air consumption	160 l/min	200 l/min
Arc ignition	Contact BACK STRIKING	Contact BACK STRIKING
Power regulation	Stepless	Stepless
Insulation class	F	F
IP Rating	IP 23	IP 23
Dimensions (W x L x H)	360x350x630 mm	610x340x680 mm
Weight	25 kg	39 kg
Catalogue No.	59 00 300071	59 00 300101

Recommended cutting thickness - current - cutting speed for FANCUT 101 (torch PT-100)

Mild steel			Stainless steel			Aluminium		
Thickness [mm]	Cutting current [A]	Cutting speed [mm/min]	Thickness [mm]	Cutting current [A]	Cutting speed [mm/min]	Thickness [mm]	Cutting current [A]	Cutting speed [mm/min]
4	40	2500	4	40	2300	4	40	3000
6	60	1700	6	60	1500	6	60	2000
10	60	1000	10	60	800	10	60	1100
12	80	900	12	80	800	12	80	900
15	80	600	15	80	550	15	80	650
20	100	600	20	100	550	20	100	650
25	100	400	25	100	300			
30	100	300						

The recommendations apply for an air pressure of 5,5 - 6,0 bar and a flow rate of 210 l/min.

RYWAL-RHC Sp. z o.o.

ul. Polna 140B, 87-100 Toruń
tel. 56 66-93-800

