

# T26V SGRIP MOST - TIG welding torch

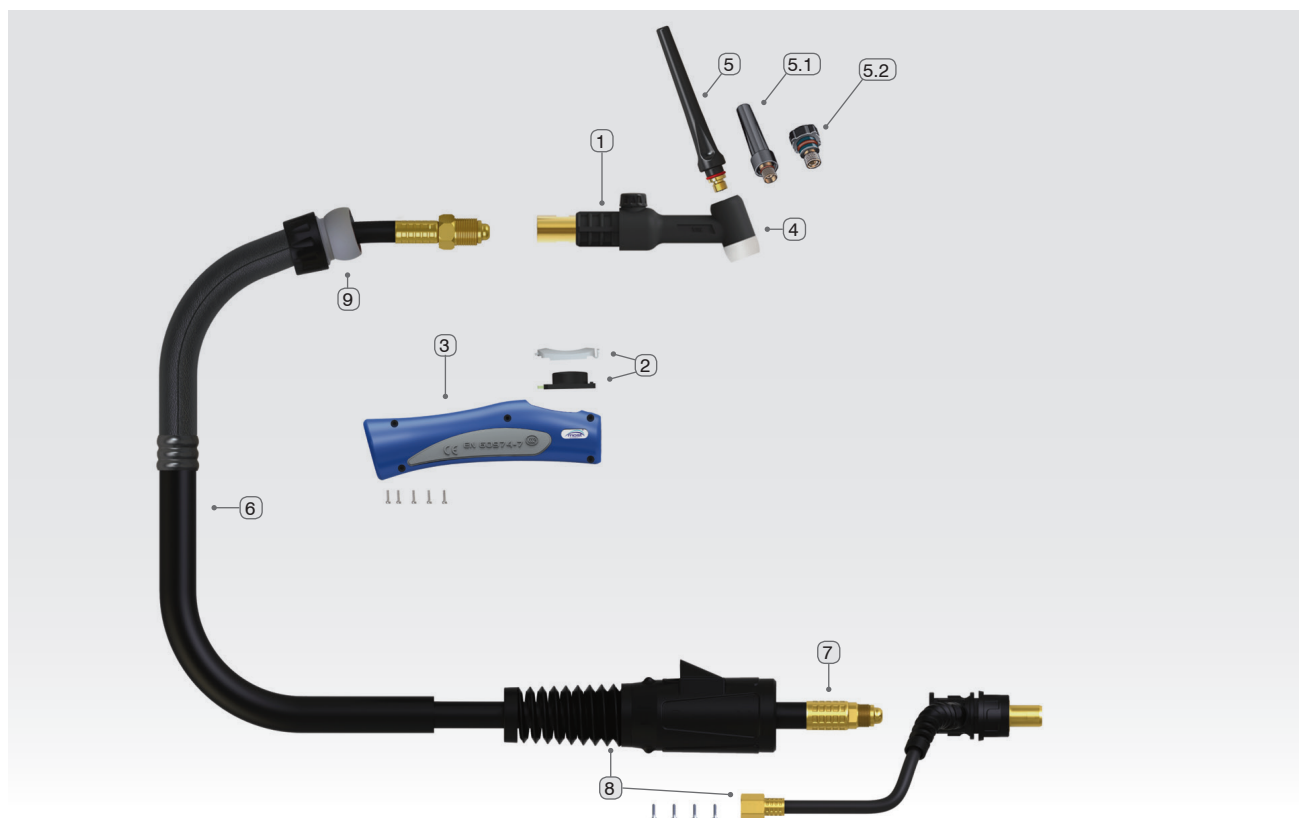

Model	T26V SGRIP
<b>Cooling</b>	Gas
<b>Technical data according to EN 60 974-7:</b>	125 A AC / 180 A DC
▪ Rating 35% duty cycle	1,0-3,2 mm
▪ Tungsten electrode diameter	5-12 l/min
▪ Gas flow	
<b>Length / Catalogue No.</b>	4,0 m / 56 01 062634 8,0 m / 56 01 062638

No.	Replaceable elements	Catalogue No.	Alternative designation
1	<b>T-26V MOST* torch body</b>	56 13 003363	UWP26V
1.1	<b>T-26VF MOST torch body</b>	56 13 003370	UWP26VFX
2	<b>TIG button cover</b>	56 13 200105	UERBS
3	<b>TIG SGRIP large torch</b>	56 13 200220	RY-ERH200
4	<b>T-17/18/26 insulator</b>	56 13 014810	18CG
5	<b>Long back cup T-17/18/26</b>	56 13 003181	57Y02
5.1	<b>Medium back cup T-17/18/26</b>	56 13 003251	-
5.2	<b>Short back cup T-17/18/26</b>	56 13 003270	57Y04
6	<b>Cable cover (m)</b>	51 13 015289	-
6.1	<b>Cable cover 4 m</b>	56 13 200250	USLERC200-40
6.2	<b>Cable cover 8 m</b>	56 13 200251	USLERC200-80
7	<b>Power gas cable T-26 MOST 4 m</b> <b>Power gas cable T-26 MOST 8 m</b>	56 13 200212 56 13 200213	USL46V28AOB USL46V30AOB
8	<b>TIG26 plug assembly</b>	56 13 200272	UNSL 35-50-26-GS5
9	<b>TIG joint</b>	56 13 200264	UERKJ200

T26VF SGRIP version with a flexible torch, technical data as for T26 SGRIP.

Torches are supplied with a gas cap.

V - torch with gas valve, without button.

F - flexible torch.

DC - direct current.

AC - alternating current.

\* standard version